

SLOUCH.

LET'S ASSEMBLE YOUR CHAIR.

WHAT'S IN THE BOX

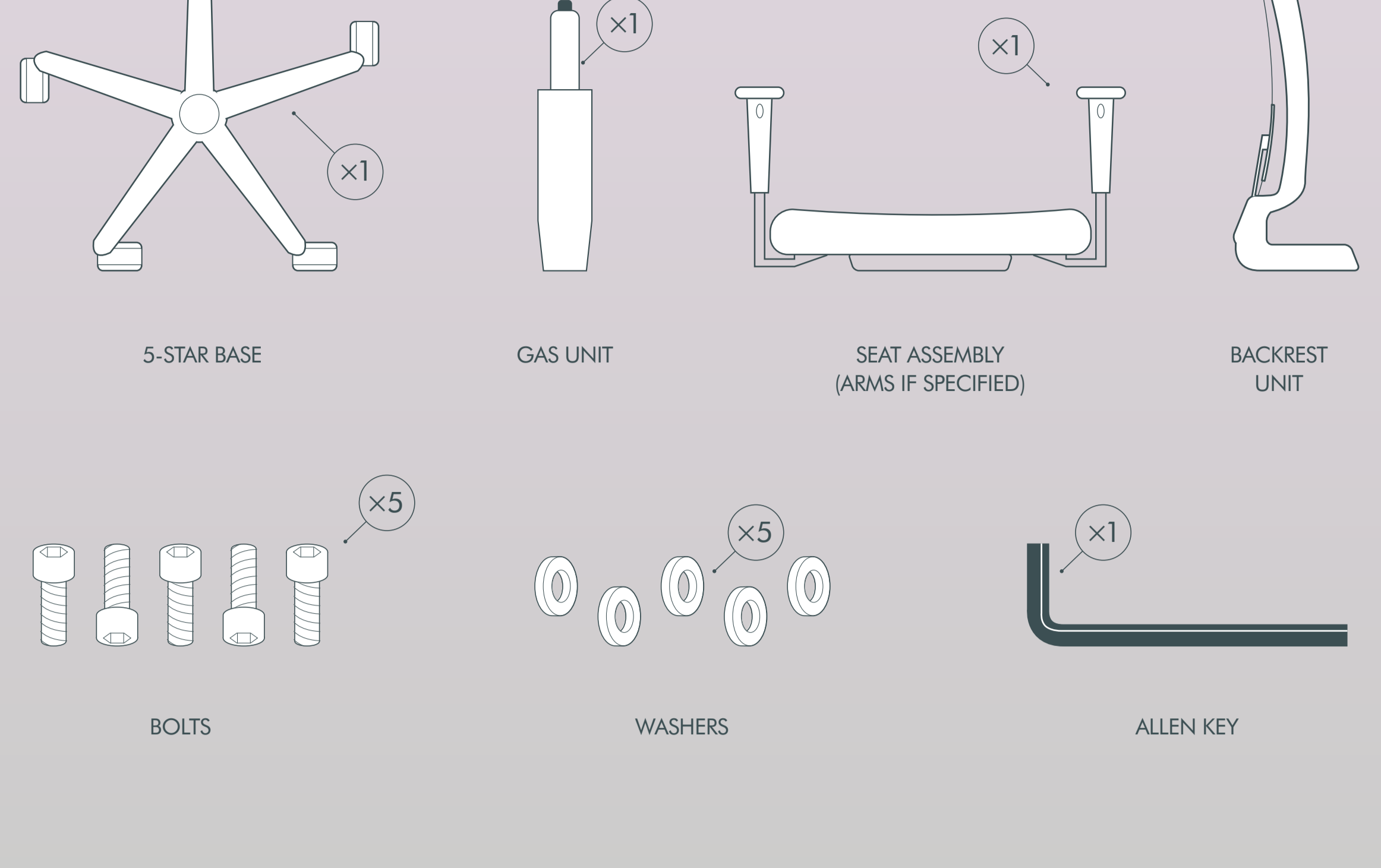

STEP ONE

Align backrest unit with seat.



STEP TWO

Combine the five washers with the five bolts. Align the five holes and insert the bolts — tighten with the allen key supplied.



STEP THREE

It's time to put it all together... insert the three components together and enjoy the best sit of your life!



WE'VE GOT YOUR BACK

SLOUCH.

IMPORTANT INFORMATION

- The product should only be assembled and used on firm, level ground.
- Keep small parts out of reach of children.
- Ensure the product is fully assembled as illustrated before use.
- Check the pack and make sure you have all the parts listed.
- Check all screws or bolts are tightened and inspected regularly.
- Do not overtighten screws or bolts.
- Do not stand on the product.
- Do not use power tools to construct as overtightening and part failure may occur.

IF IN DOUBT ASK

Email— customercare@slouchonline.com

SLOUCH.